



Generations of family fun.

DESIGNER™



DESIGNER

2
YEAR
WARRANTY





#LETSJAYCO

Where do you want to go? With Jayco, you're headed straight for family fun—regardless of the destination. From wooded campgrounds to sandy beaches, swimming hole docks to scenic byways, maximize the moment with unmatched quality and added comfort. So what are you waiting for? Make new memories—and share them with the world.

GENERATIONS OF FAMILY FUN

NEARLY 50 YEARS OF ENGINEERING, LISTENING, LEARNING AND EVOLVING

Jayco has been building fifth wheels for nearly a half-century—and Luxury Fifth Wheels for almost 30 years.



* DSI award win

Jayco has been awarded the prestigious RVDA DSI Quality Circle Award for nine years running, winning over 75 awards across all of its product lines. The award, based on a survey of hundreds of RV dealers in the U.S. and Canada, takes into account product quality, value, service/support and more.

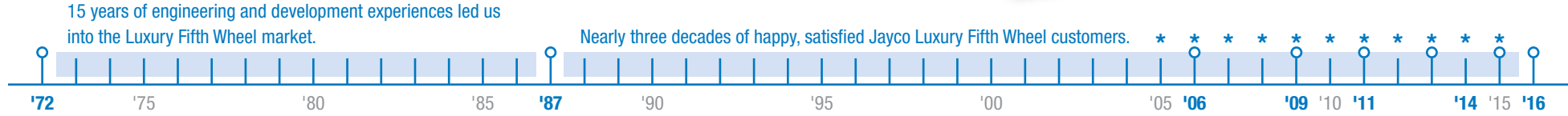

- 1972** Jayco introduces its first fifth wheel, the Wonderland
- 1987** Jayco introduces its first Luxury Fifth Wheel, the Designer
- 2006** Jayco fifth wheels win a DSI award—and we've won it every year since
- 2009** Engineering breakthroughs: Jayco introduces a drop-frame design and wide-stance landing gear

- 2011** Jayco introduces the Pinnacle line, which raises the bar in the Luxury Fifth Wheel market
- 2014** Jayco debuts the 375BHFS Eagle Premier, a SuperSlide bunk model that overtakes the luxury market
- 2016** The North Point line is born, and the Designer is reborn—raising the bar again in the luxury market

On the cover—39RE with optional Horizon Sands full-body paint package

DESIGNER

LIVE THE LEGACY

When Jayco founder Lloyd Bontrager set out to build a better camping trailer nearly 50 years ago, he probably couldn't have imagined the lavish craftsmanship, awe-inspiring floorplans and stunning residential amenities we'd accomplish years later. Today, his legacy of excellence lives on—with Luxury Fifth Wheels that are as plush as they come.

JAYCO'S ALL-SEASONS CAMPING PACKAGE

Longer camping seasons mean more fun and more memories. That's why we build our Luxury Fifth Wheels with a blend of enhanced features that keep you and yours comfortable regardless of your camping plans. Simply put, we make it easier for you to camp more.



Jayco Climate Shield™

Your trailer stays comfy and functional, even in extreme temperatures, thanks to a fully enclosed and heated underbelly, double-sided Flexfoil® insulation, G20 dark-tinted windows and durable PEX plumbing. See more on page 11.



Magnum Truss™ XL6 Roof System

The strongest roof available on an RV also features a unique design that allows more room for insulation to keep you cozy during chilly nights and cool on the steamiest summer days.

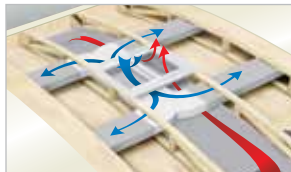

Helix Cooling System

Curved ducts and a residential air return system keep conditioned air moving efficiently when you need it most.



Jayco Luxury Sleep System

You'll sleep like a baby in any kind of weather on your Simmons® residential foam-top mattress.



Magnum Frame System

Extra wide steel beams and added support in the cargo, upper deck and hitch areas make for one of the most stable foundations in the industry.



Mega-Wall Sidewalls

Vacuum-bonded and double-layer laminated walls stand up to the elements.



Electric Fireplace

Flip the switch and forget all about any unseasonably cool weather outside.



Full-Timer Kitchen Storage

Spacious and convenient storage helps keep you equipped for cooking and dining al fresco or in the comfort of your luxurious fifth wheel.

HERE'S WHY WE CAN OFFER THE INDUSTRY'S LONGEST WARRANTY

From concept to completion, every step of the way, we pay the closest attention to the little things that make our RVs stronger, more durable and more reliable than the competition. It's the reason that, with support from our select partners, we have you covered for **2 camping seasons**. That's **730 days**—no strings attached. So go explore. We have the warranty that will follow you anywhere.



4 RAISING EXPECTATIONS

You'll be hard-pressed to find a more comfortable way to travel. Thoughtful design, meticulous construction and premium features like those in the Luxury Fifth Wheel and Designer Advantage packages set the bar in towable luxury.

Luxury Fifth Wheel Package:

- 6-point electric auto-leveling system (1)
- Carefree® power awning with Flex Guard fabric shield and LED light strip (2)
- Magnum Truss™ XL6 Roof System (3)
- Helix Cooling System with Whisper Quiet technology (4)
- Full-timer kitchen storage (5)
- Indoor/outdoor central vacuum system with kick pan (6)
- Magnum Frame System (7)
- Quad-tread aluminum entrance steps (8)
- Franklin™ American-made residential furniture (9)
- Backup camera prep
- Bluetooth®/HDMI® high-output entertainment system
- Cargo accessory receiver
- Electric, thermostat-controlled fireplace
- Keyless main entrance door
- LED exterior lighting
- MOR/ryde® pin box
- Oversized battery compartment
- Painted gelcoat fiberglass front cap
- Power kitchen vent with wall controls
- Sidewall- and roof-mounted solar prep
- Whole-coach water purification system



1



2



3

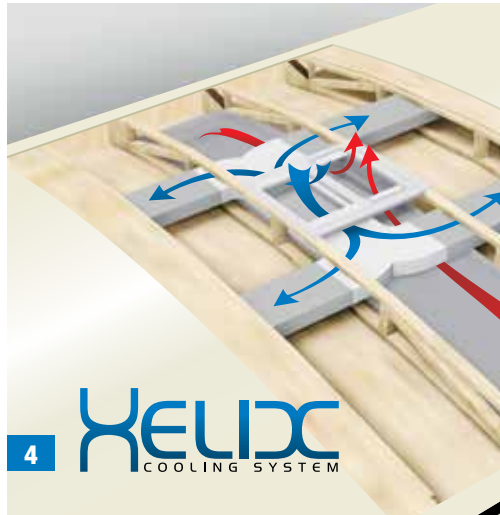

4

HELIX
COOLING SYSTEM



5



6



7



8



9



Designer Advantage Package:

Mega-Wall double-layer laminated sidewalls (1)

Residential dishwasher (2)

One Control Android command system (3)

Oversized, apron-style stainless steel sink (4)

Trash can/cutting board (5)

Induction cooktop (6)

Residential crown molding in living areas (7)

39-inch hidden bedroom LED HDTV (8)

Samsung® Professional Theater system in main living area, featuring Samsung HDTV, Samsung Soundbar with built-in subwoofer and Samsung Blu-Ray™ player (9)

8,000-pound axles

17.5-inch H-rated tires and custom rims

30,000-BTU dual Whisper Quiet A/C system

Tree Topper 8-foot slideouts in main living area

Jayco Luxury Sleep System featuring Simmons® residential foam-top mattress

Gel 360 gelcoat fiberglass on front cap, rear cap, sidewalls, entrance doors and baggage doors

Oversized residential king showers

Oversized quad-tread aluminum entrance steps

LED-lighted slideout fascia and window treatments in living areas

Living area window boxes with hardwood valances

MOR/ryde LRE4000™ rubberized suspension system

Multiplex lighting

Stainless steel convection microwave

Triple 30-pound capacity propane tanks

Bedroom CD/DVD/radio

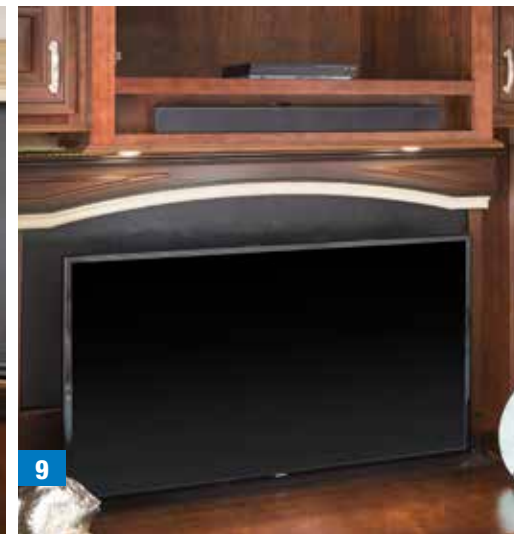
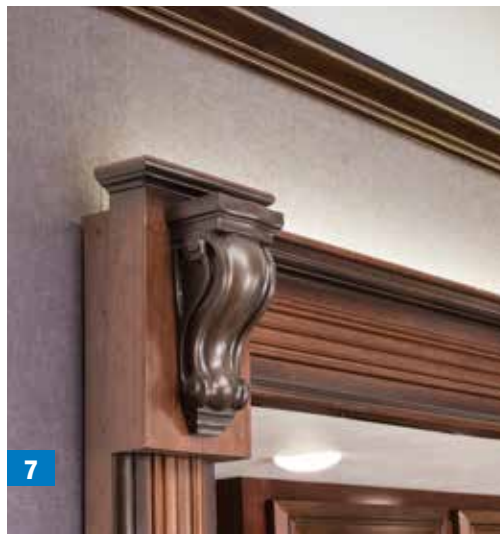
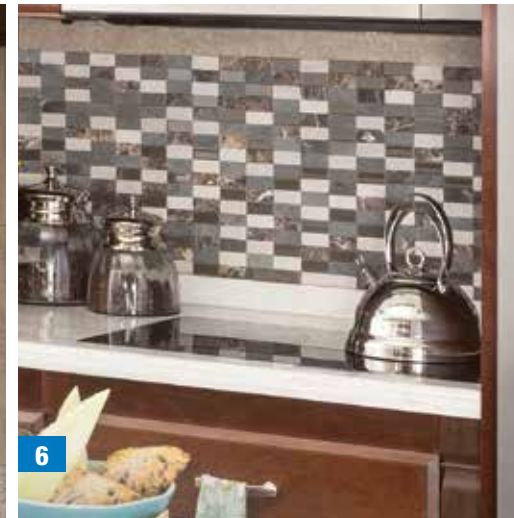
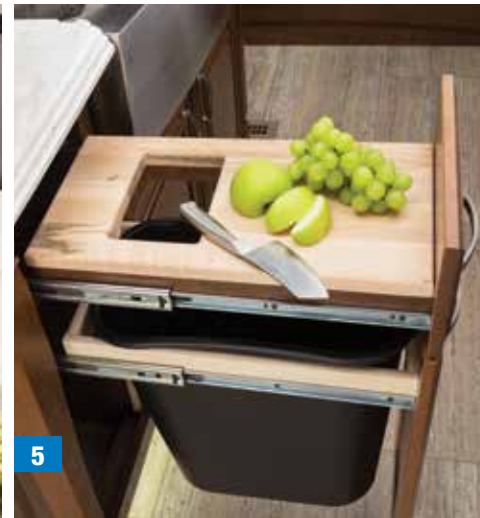



37RS DINETTE/DESK



37RS 7-INCH DIGITAL SWITCH



37RS ENTERTAINMENT CENTER



39RE POWER THEATER SEATING



37RS BATHROOM



37RS WINDOW TREATMENTS



39RE | MIDNIGHT

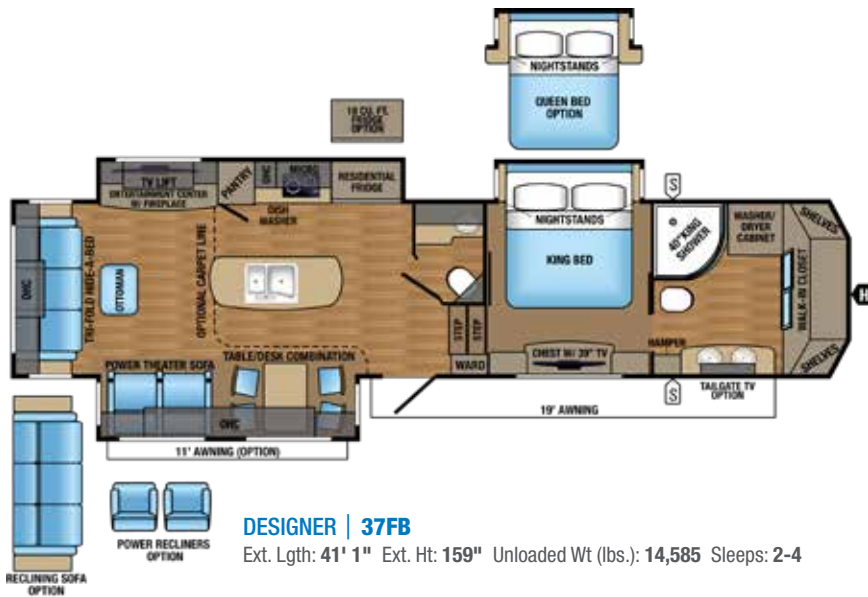

37RS | DUNES

**DESIGNER | 37FB**

Ext. Lgth: 41' 1" Ext. Ht: 159" Unloaded Wt (lbs.): 14,585 Sleeps: 2-4

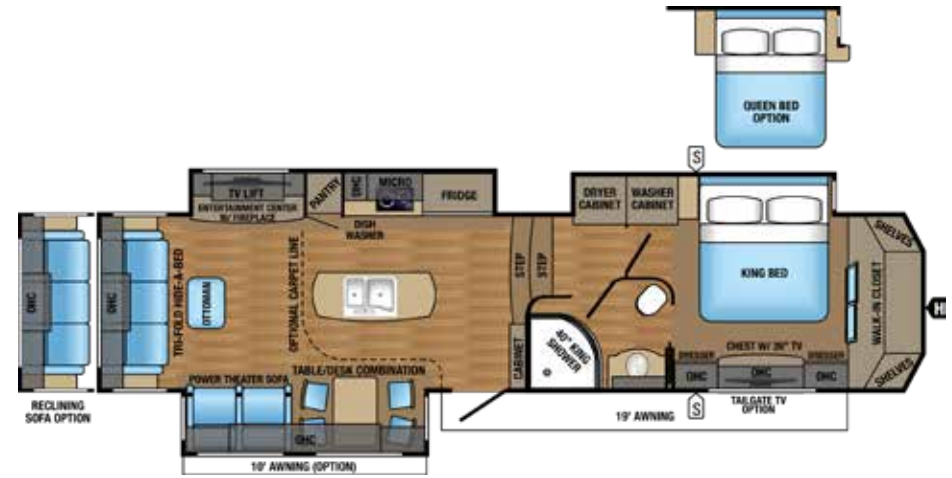
**DESIGNER | 37RS**

Ext. Lgth: 40' 1" Ext. Ht: 160" Unloaded Wt (lbs.): 14,370 Sleeps: 2-4

**DESIGNER | 39FL**

Ext. Lgth: 41' 6" Ext. Ht: 159" Unloaded Wt (lbs.): 14,815 Sleeps: 6

**DESIGNER | 39RE**

Ext. Lgth: 42' 5" Ext. Ht: 159" Unloaded Wt (lbs.): 15,115 Sleeps: 6

MODELS		DIMENSIONS					WEIGHT (LBS.)				TANKS (GALS.)		
FLOORPLAN	TOTAL EXTERIOR LENGTH	EXTERIOR TRAVEL LENGTH*	EXTERIOR WIDTH	EXTERIOR HEIGHT (WITH A/C)	EXTERIOR HEIGHT (WITH OPT. BEDROOM A/C)	INTERIOR HEIGHT (UPPER DECK)	UNLOADED VEHICLE WEIGHT	DRY HITCH WEIGHT	GROSS VEHICLE WEIGHT RATING	CARGO CARRYING CAPACITY	FRESH WATER CAPACITY (INCLUDES WATER HEATER)	GREY WASTE WATER CAPACITY**	BLACK WASTE WATER CAPACITY
37FB	41' 1"	39' 9"	102"	159"	160"	85"	14,585	2,805	17,500	2,915	85	95	50
37RS	40' 1"	38' 9"	102"	160"	160"	85"	14,370	3,065	17,500	3,130	85	95	50
39FL	41' 6"	40' 5"	102"	159"	160"	85"	14,815	3,065	17,995	3,180	85	117	37
39RE	42' 5"	41' 2"	102"	159"	159"	85"	15,115	2,796	17,995	2,880	85	95	50

Unloaded Vehicle Weight (UWV): Sometimes referred to as "Dry Weight," UWV means the typical weight of this trailer as built at the factory. The UWV, as used in product literature and other promotional materials, does not include cargo, fresh water, propane, options or dealer-installed accessories.

Gross Vehicle Weight Rating (GVWR): GVWR means the maximum permissible weight of the trailer, including the UWV plus passengers, personal items, all cargo, fluids, options and dealer-installed accessories. The GVWR is equal to or greater than the sum of the UWV and the CCC.

*Distance from the pin box to the bumper; total exterior length may be longer

**Split Tank

Cargo Carrying Capacity (CCC): CCC means the maximum weight of all passengers, personal items, food, fresh water, propane, tools, other cargo and dealer-installed accessories that can be carried by the trailer. CCC is equal to or less than GVWR minus UWV. The addition of options will decrease the CCC.

Hitch Weight (HW): The hitch weight, as used in product literature and other promotional materials, does not include cargo, fresh water, propane gas, options or dealer-installed accessories. The addition of these types of items will either add to or subtract from the stated hitch weight.

It is important for your safety and enjoyment that your tow vehicle be adequately sized and equipped to tow and handle the GVWR of the RV you select. Review weights and rating of your tow vehicle and consult a competent advisor for questions or advice. Whether you are new to RVing or a veteran, get a feel for the performance of your tow vehicle before heading out on the roadways. When you tow an RV, you must drive differently than when you drive a single vehicle. Practice hooking up, driving, backing up and braking in a safe environment or seek out professional instruction. Jayco affixes a weight label to each RV which lists weight information for that vehicle. See specifications chart above.

EXTERIOR OPTIONS



SANDSTONE PARTIAL PAINT (STANDARD)



CARBON STEEL FULL-BODY PAINT (OPTIONAL)



CRIMSON WAVE FULL-BODY PAINT (OPTIONAL)



HORIZON SANDS FULL-BODY PAINT (OPTIONAL)

INTERIOR DÉCOR

MIDNIGHT



SOFA/CHAIR



MAIN ACCENT



LINOLEUM



CARPET

ROSEWOOD

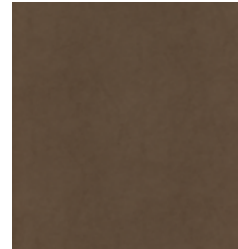

SOFA/CHAIR



MAIN ACCENT



LINOLEUM



CARPET

DUNES



SOFA/CHAIR



MAIN ACCENT



LINOLEUM



CARPET

STORMCLOUD



SOFA/CHAIR



MAIN ACCENT



LINOLEUM

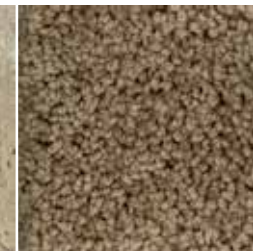

CARPET

LUXURY FIFTH WHEEL PACKAGE (mandatory)

- 6-point electric auto-leveling system
- Backup camera/monitoring system prep
- Carefree® power awning with Flex Guard fabric shield and LED light strip
- Indoor/outdoor central vacuum system with kick pan
- Franklin™ American-made residential furniture
- 12-inch Magnum Frame System
- Magnum Truss™ XL6 Roof System
- Helix Cooling System featuring a Jayco-exclusive duct design, exterior-mounted A/C units, directional/closable A/C vents, and larger return air vents with user accessible filters
- Quad-tread aluminum entrance steps
- Bluetooth®/HDMI® high-output entertainment system
- Cargo accessory receiver
- Electric, thermostat-controlled fireplace
- Keyless main entrance door
- LED exterior lighting
- MOR/ryde® pin box
- Oversized battery compartment
- Fully painted and clear-coated front cap
- Power kitchen vent with wall controls and rain sensor
- Sidewall- and roof-mounted solar prep
- Whole coach water purification system
- Full-timer kitchen storage system

DESIGNER ADVANTAGE PACKAGE (mandatory)

- 8,000-pound axles
- 17.5-inch H-rated tires
- Mega-Wall double-layer laminated sidewalls
- 30,000-BTU dual Whisper Quiet A/C system
- 39-inch bedroom LED HDTV
- Tree Topper 8-foot slideouts in main living area
- Jayco Luxury Sleep System with 80-inch Simmons® residential foam-top mattress
- Residential dishwasher
- Gel 360 front cap, rear cap, sidewalls, entrance and baggage doors
- Induction cooktop
- Oversized residential king showers
- LED-lighted slideout fascia and window treatments in living areas
- Residential hardwood window box casing
- MOR/ryde LRE4000™ rubberized suspension system
- One Control Android-based complete command system, featuring multiplex lighting and digital 7-inch touchscreen controls
- Oversized, stainless steel, apron-style sink
- Residential hardwood cabinet crown molding
- Stainless steel convection microwave
- Triple 30-pound capacity propane tanks
- Samsung® Professional Theater system in main living area, featuring Samsung HDTV, Samsung Soundbar with built-in subwoofer, and Samsung Blu-Ray™ player
- Bedroom CD/DVD/radio

CUSTOMER VALUE PACKAGE (mandatory)

- 15,000-BTU central A/C
- Arched interior ceiling with 82-inch upper deck interior height
- Bath skylight
- Bathroom power vent
- Bedsprad
- Under-bed floor safe
- Oversized folding exterior grab handle
- Frameless G20 dark-tinted windows
- LED interior lighting
- Security lights
- Slam-latch™ baggage doors with strut assist
- Sofa and bed pillows
- Solid-surface kitchen countertops
- Keyed-Alike™ exterior doors locking system

STANDARD EXTERIOR EQUIPMENT

- Partial paint package with full clearcoat
- Wide-body, 102-inch frame
- Wide-stance front landing gear
- TuffShell™ vacuum-bonded, laminated walls
- Climate Shield™:
 - Enclosed, insulated, heated underbelly
 - High-BTU-output furnace (40,000-BTU)
 - Astro-Foil™ in roof and floors
- Aerodynamic front and rear cap with LED lights
- Seamless composite roof covering
- 12-inch I-class cambered structural steel I-beams
- Super Lube™ hubs
- Completely enclosed and protected slideout mechanisms
- Frameless, dark-tinted, safety-glass windows
- 30-inch x 78-inch entry door with oversized window
- Exterior marine-grade speakers (2)
- Front awning arm convenience outlet
- ExpansiView opera-style, floor-to-ceiling dining area windows
- Enclosed, protected basement drop-frame
- Cable TV and outlet in basement
- Stor-Galore™ pass-through basement storage with slam latches and strut assist
- Heated, enclosed Uni-Dock™ utility center
- 50-amp power retractable cord reel
- 75-gallon fresh water tank
- 50-gallon black tank capacity minimum
- Cable and satellite input ports
- Roof prepped and framed for roof-mounted satellite
- Non-crank digital HDTV antenna
- Outside grill prep
- Under-mounted spare tire
- Roof ladder
- Hitch light
- Upper deck slideout convenience light
- MOR/ryde cargo area tool drawer
- EZ-Cord™ cargo area extension cord access port

STANDARD INTERIOR EQUIPMENT

- Custom residential miter-cut cherry cabinet doors with hidden hinges
- Satin-nickel, custom residential cabinet hardware
- Hardwood cherry cabinet stiles
- Hardwood framed headboard
- Hardwood hallway steps with center carpet runners
- Iron hallway assist railing
- Iron interior assist handle
- Hardwood slideout fascias
- Decorative paneling with chair rail and baseboard in select living areas
- Decorative interior entryway light fixture
- Residential-style pantry
- Trash can drawer with butcher block cutting board drawer above
- Steel ball-bearing drawer guides, 75-pound capacity with full extension
- Residential-grade, pullout kitchen faucet
- Water heater bypass
- 23-cubic-foot residential refrigerator with water/ice in door
- 1,000-watt inverter
- Residential-grade, travertine-look vinyl flooring
- Shaw® R2X® stain-resistant residential carpeting
- Night-light toe kick lighting in bedroom, bathroom and kitchen
- 90-amp power center with Charge Wizard®
- Closeable and directional A/C vents
- Tri-fold hide-a-bed sofas with ottoman
- Power theater seat sofa
- Ceiling fan (n/a on 39FL)
- Class A-style hardwood ceiling mantle with LED accent lighting
- LED ceiling lights throughout
- Porcelain bath stool with foot flush
- Under-mounted stainless steel bathroom lavatory sink
- Solid-surface bathroom lavatory backsplash
- Kingston cherry cabinetry in bathrooms
- Robe hooks in bathroom
- Hardwood headboard
- Oversized drawer storage in bed base
- Walk-in-style front closet with dual hanging rods and cedar lining
- Mullion-style front wardrobe doors
- Washer/dryer prep (accommodates stackable unit)
- Oversized bedroom dresser storage
- Bedroom slide fascia built-in nightstand storage system
- Dual USB charging centers in kitchen, near sofa in living area, and near nightstand in bedroom
- DVD/radio receiver in bedroom

OPTIONS

- Customer Value Package with heat pump
- Kingston cherry cabinetry package
- Hydraulic disc brakes
- Simmons 60-inch x 80-inch queen residential foam-top mattress
- Simmons Beautyrest® luxury 11.5-inch foam-top king bed
- Simmons Beautyrest luxury 11.5-inch foam-top queen bed
- Carpet in living area (n/a on 39FL)
- Reclining sofa (n/a on 39FL)
- Power recliner chairs (2) in lieu of theater seating (37FB)
- 18-cubic-foot 2-way Norcold® refrigerator with ice maker
- Backup camera and monitoring system
- Tailgate TV: 39-inch cargo-area TV on sliding bracket
- Third ducted 15,000-BTU A/C
- Generator prep
- 5,500-watt generator
- Extreme Weather Package: 110V heat pads on holding tanks, 12V wrapped fresh water line
- Dual-pane all-weather windows
- Second power awning with Flex Guard (37RS, 39RE)
- Slideout awning covers
- On-demand tankless water heater system
- Sani-Con® sewer macerator pump system
- 2 additional dinette chairs
- Horizon Sands Premium full cut-and-buff exterior paint package
- Carbon Steel Premium full cut-and-buff exterior paint package
- Crimson Wave Premium full cut-and-buff exterior paint package

MAKING MEMORIES THAT LAST GENERATIONS—LET'S JAYCO



THE JAYCO DIFFERENCE

- Vacuum-bonded, Mega-Wall sidewalls** for better protection from the elements
- Optional automotive-grade, cut-and-buff, full-body paint package (partial paint standard)** and Gel 360 premium gelcoat fiberglass front cap, rear cap and sidewalls for a sleek, durable exterior
- Magnum Truss XL6 Roof System** withstands 4,500 pounds—50 percent more than other roofs
- Welded aluminum frame** for a durable, lightweight structure
- Double layer of fiberglass insulation** behind the front cap, plus Flexfoil® and fiberglass insulation in the floor to provide extra warmth where it's needed most—in the bedroom
- Painted gelcoat fiberglass front cap** withstands the rigors of the road with infused paint and gel coating, plus 1/4-inch plywood bracing for additional support—not typically found on competing fifth wheels

Whether you're out for excitement, relaxation or just time together, we take steps others don't to help you stay focused on the fun. No cutting corners here. Let us go the extra mile so you don't have to.

- 17.5-inch H-rated tires and custom rims**
- Hydraulic disc braking system (optional)**
- MOR/ryde LRE4000 rubberized suspension system** provides smoother towing and better protection from damaging road shock
- Helix Cooling System with Whisper Quiet technology**
- 6-point electric leveling system**
- Carefree power awning** with Flex Guard fabric shield
- Quad-tread aluminum entrance steps**
- Keyless main entrance door**
- Cargo accessory receiver**
- Sidewall- and roof-mounted solar prep**
- MOR/ryde pin box**
- Magnum Frame System**
- Backup camera**



JAYCO'S ROOF **VS** OTHER ROOFS



4,500 POUNDS ON A JAYCO ROOF VS. OTHER ROOFS

THE MAGNUM TRUSS™ XL6 ROOF SYSTEM
50 percent stronger



CLIMATE SHIELD

Extend your camping season with the Jayco Climate Shield. It protects against extreme heat and extreme freezing—even in temperatures as high as 100 degrees or as low as zero degrees (Fahrenheit).* Scan the QR code to see the Climate Shield video.

LIVING ROOM



KITCHEN



BATHROOM



HOLDING TANK



BEDROOM



*Jayco tested fifth wheels in zero degrees F and 100 degrees F weather over an extended period of time in a controlled environment, and all functions of the coach were fully operational. Testing was done in a completely controlled environment; therefore, temperatures during testing may not represent actual temperatures in nature and cannot account for elements such as wind or moisture. In actual use, unit may not perform as well. Supplier of cooling components does not guarantee anything better than 20 degrees difference from ambient temperature. In addition, outside components are subject to freezing and require steps to properly insulate. Jayco's limited warranty does not cover damage caused by freezing. To learn more about Climate Shield and testing done by Jayco, visit www.jayco.com.

WE START WITH ONE OF THE INDUSTRY'S
strongest
foundations

Full-width outriggers: We build on full-width outriggers that are spaced 4-6 feet apart (vs. 8 feet) to better support the weight of the wall.

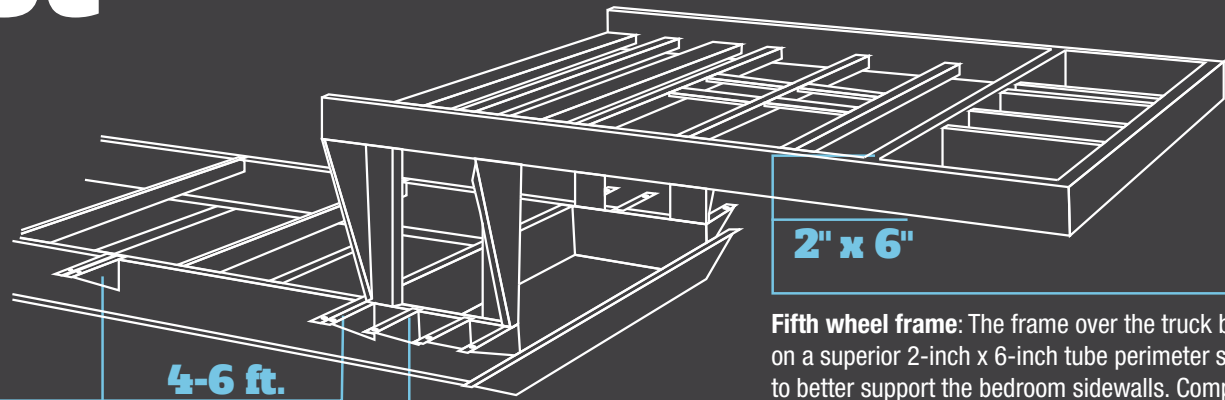

I-class cambered structural steel I-beams: Jayco uses a unique molded, one-piece design to prevent unit from twisting; competing three-piece I-beams can warp over time at the welded seams.

2" x 6"

Fifth wheel frame: The frame over the truck bed is built on a superior 2-inch x 6-inch tube perimeter structure to better support the bedroom sidewalls. Competing fifth wheels have a smaller frame; these manufacturers add a sidewall support seam to compensate for expansion joints.

Learn more at StrongFoundation.Jayco.com



Meet your Jayco Dealer

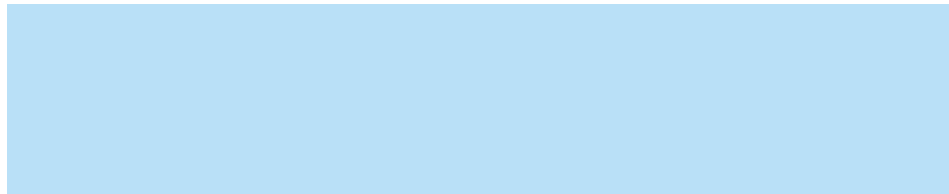

We work hard—so you can play hard. From finding the perfect Jayco for your family to providing flexible financing options and full-service support, we're here to help.

Follow Jayco



Jayco, Inc., P.O. Box 460, Middlebury, IN 46540, www.jayco.com See dealer for further information and prices. All information in this brochure is the latest available at the time of publication approval. Jayco reserves the right to make changes and to discontinue models without notice or obligation. Photos in this brochure may show optional equipment and props for photography purposes. RVs built for sale in Canada may differ to conform to Canadian codes. ©2016 Jayco, Inc. 274741 1016-10K Printed in U.S.A.

Travel with Confidence



At Jayco, we build our RVs to handle every adventure, then back them with our industry-leading 2-year limited warranty. We, with support from our select partners, have you covered for **2 camping seasons**. That's **730 days**. You won't find a better warranty in the business, because the only strings we attach are those that deliver the ultimate in reliability. That's the Jayco difference. So go explore. We have the warranty that will follow you anywhere. For a copy of our 2-year limited warranty with complete terms and conditions, please contact your local Jayco dealer.



A year's access to Coach-Net™—the country's largest RV emergency road service.



eco advantage™

Jayco's long-term commitment to generations of family fun

After five years of increased efforts to eliminate waste, conserve energy and increase recycling, we've come a long way in building RVs that are not only better for your family—but also better for the planet.

Learn more at Jayco.com/EcoAdvantage